

8434 2017 00 2014:01

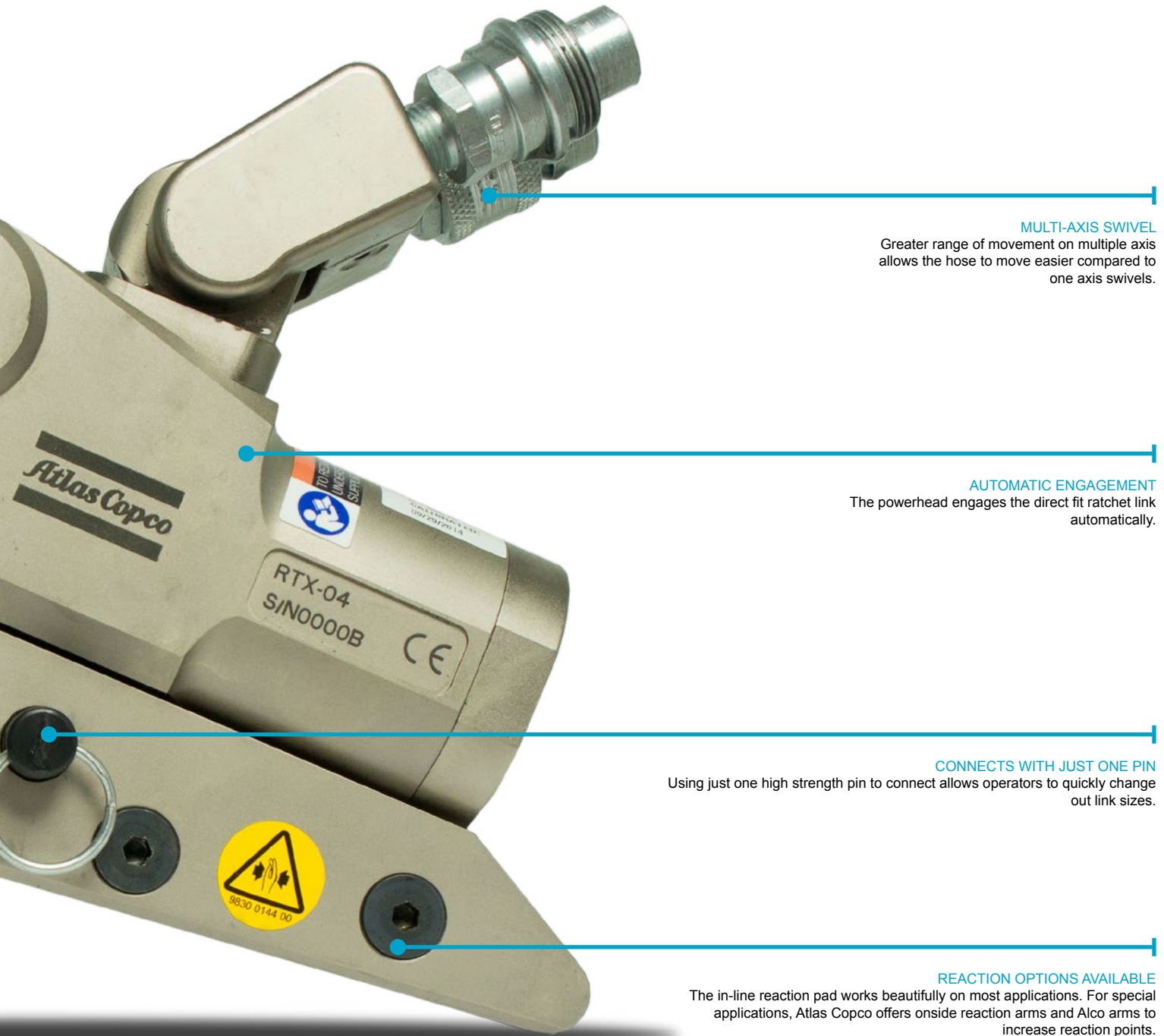

MULTI-AXIS SWIVEL
Greater range of movement on multiple axis allows the hose to move easier compared to one axis swivels.

AUTOMATIC ENGAGEMENT
The powerhead engages the direct fit ratchet link automatically.

CONNECTS WITH JUST ONE PIN
Using just one high strength pin to connect allows operators to quickly change out link sizes.

REACTION OPTIONS AVAILABLE
The in-line reaction pad works beautifully on most applications. For special applications, Atlas Copco offers onside reaction arms and Alco arms to increase reaction points.

**RTX SERIES
LOW PROFILE
HYDRAULIC TORQUE WRENCH**

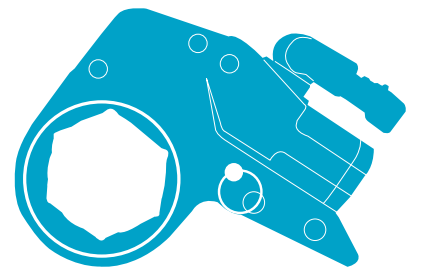

The worldwide standard for powerful torque output on low clearance applications.



COMMITTED TO SUSTAINABLE PRODUCTIVITY

We stand by our responsibilities towards our customers, towards the environment and the people around us. We make performance stand the test of time. This is what we call - Sustainable Productivity.



RTX SERIES

**LOW PROFILE
HYDRAULIC TORQUE WRENCH**

Our Rapid-Torc RTX direct-fit, low profile torque wrenches combine high power-to-weight ratio, durability and hands-free operation. The result is a tool that is perfectly suited for low clearance applications that require high torque. Use with the standard set up or customize with high quality accessories.

From design, to manufacturing and calibration, RTX Series is a purpose-built machine. It stands second to none.

AIRCRAFT ALUMINUM ALLOY
Most of the exterior is made up of aircraft-quality aluminum alloy, which provides amazing strength while keeping weight to a minimum.

LARGEST HEX RANGE
Largest range of hex sizes available. Torque output is consistent for any link size. Available in Reduced Radius and 12 point.

HIGH STRENGTH STEEL ALLOY
Heavy duty contact points ensure long tool life.



RTX SERIES

LOW PROFILE HYDRAULIC TORQUE WRENCH

KEY FEATURES

6 Models torque range 255 ft. lb. to 31800 ft. lb. (346 Nm to 43108 Nm)

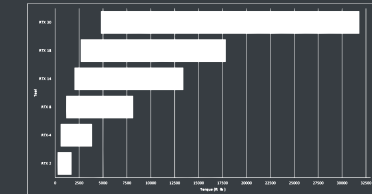

Hex Drive Size

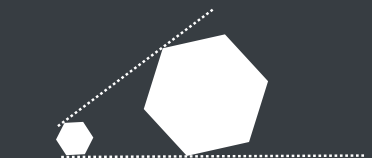

Ranges from 3/4" to 6 1/2"

+/- 3% Accuracy

- 1 Standard Setup
- 2 Standard Link Sizes
- 3 Insert Hex Reducer
- 4 Safety Handle for RTX
- 5 Alco Arm
- 6 Onside Reaction Arm
- 7 Safey nut

1 STANDARD RTX SERIES SETUP

RTX Powerhead
Choose your torque range.



Direct Fit Ratchet Links
Choose the Across Flat Hex Link Size* needed for your application. Available in Reduced Radius#.



Model	Dimensions									
	L		NS (based on ratchet link size)		R		W1		W2	
	in	mm	in	mm	in	mm	in	mm	in	mm
RTX-02	7.2	183	1/2 - 2 9/16	19-65	0.35	9	1.26	32	1.92	49
RTX-04	9.7	248	1 5/16 - 3 1/4	32-80	0.47	12	1.65	42	2.56	65
RTX-08	12.1	308	1 13/16 - 3 1/4	46-100	0.59	15	2.08	53	3.22	82
RTX-14	14.6	372	2 - 4 5/8	50-120	0.72	18.5	2.48	63	3.89	99
RTX-18	15.5	393	3 - 5 1/2	75-140	.87	22.2	2.75	70	4.37	111
RTX-30	18	457	3 9/16 - 6 1/4	90-155	1	25.4	3.26	83	5.28	132

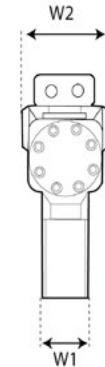
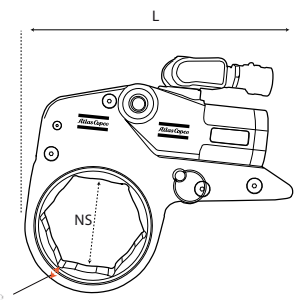

Model	Ratchet Link Hex Size*	Torque Range		Weight		Ordering No.	
		ft. lb.	Nm	lbs	kg		
RTX-02	1/2 - 2 1/4	19-65	255-1710	346-2318	4.5	2	8434 2021 90
RTX-04	1 - 3 1/4	25-85	580-3855	786-5226	9.7	4.4	8434 2021 95
RTX-08	1 1/4 - 4 1/4	46-105	1143-8151	1549-11049	19.5	9	8434 2022 00
RTX-14	2 1/2 - 5 1/2	60-135	2010-13400	2725-18165	33	15	8434 2116 58
RTX-18	3 1/2 - 5 1/2	75-140	2676-17845	3628-24191	51	23	8434 2022 05
RTX-30	3 1/2 - 6 1/4	90-165	4770-31800	6466-43108	78	35.5	8434 2022 10

2 RATCHET LINKS



Model	Ordering no.
RL02-100	8434202003
RL02-101/27MM	8434213196
RL02-102	8434213199
RL02-103	8434213205
RL02-104	8434202169
RL02-104/32MM	8434213208
RL02-105	8434213214
RL02-107	8434202168
RL02-107 RR	8434202183
RL02-108/38MM	8434213220
RL02-110	8434202107
RL02-110 RR	8434202108
RL02-111/43MM	8434213226
RL02-112	8434213229
RL02-113/46MM	8434213232
RL02-113/46MM RR	8434213235
RL02-114	8434202006
RL02-200	8434213250
RL02-202	8434213256
RL02-203	8434213259
RL02-206	8434202147
RL02-207	8434213268
RL02-208	8434213271
RL02-209/65MM	8434202150
RL02-212	8434202159
RL02-215	8434202177
RL02-24MM	8434202054
RL02-30MM	8434213277
RL02-36MM	8434213280
RL02-41MM	8434213283
RL02-50MM	8434202186
RL02-55MM	8434213286
RL02-60MM	8434205928
RL04-014	8434213319
RL04-100	8434213322
RL04-108/38MM	8434213340
RL04-110	8434202135
RL04-113/46MM	8434202153
RL04-114	8434213343
RL04-200	8434213349
RL04-203	8434202171
RL04-204	8434213358
RL04-206	8434213364
RL04-208	8434213367

Model	Ordering no.
RL04-209/65MM	8434213370
RL04-212	8434213379
RL04-212 RR	8434213382
RL04-213	8434213385
RL04-215	8434213391
RL04-300	8434213400
RL04-302	8434213406
RL04-308	8434213409
RL04-36MM	8434213418
RL04-41MM	8434213421
RL04-50MM	8434213430
RL04-55MM	8434213436
RL04-55MM RR	8434213439
RL04-60MM	8434213445
RL04-70MM	8434202162
RL04-71MM	8434202163
RL04-75MM	8434202021
RL04-85MM	8434213454
RL08-100MM	8434202024
RL08-105MM	8434213496
RL08-113/46MM	8434202066
RL08-200	8434202068
RL08-203	8434202069
RL08-204	8434213520
RL08-206	8434202070
RL08-208	8434213526
RL08-209/65MM	8434211604
RL08-212	8434202144
RL08-215	8434202071
RL08-302	8434202072
RL08-305 3 5/16IN	8434202077
RL08-308	8434202074
RL08-312/95MM	8434213541
RL08-314	8434202165
RL08-404	8434202078
RL08-50MM	8434213547
RL08-70MM	8434213559
RL08-75MM	8434213565
RL08-80MM	8434213574
RL08-85MM	8434202111
RL08-90MM	8434202081
RL14-115MM	8434213604
RL14-130MM	8434213610
RL14-206	8434213613
RL14-209/65MM	8434202039
RL14-302	8434213631
RL14-308	8434213634
RL14-312/95MM	8434202042
RL14-314	8434202045

Other size ratchet links also available. Please contact your local Atlas Copco representative to get a complete list of sizes. We can also build custom links upon request.

3 INSERT HEX REDUCER



Starting Size	Reduces to	Ordering no.
2 3/4	1 5/8	4222 2134 17
2 3/4	1 13/16	4222 2134 20
2 3/4	1 7/8	4222 2134 23
46mm	36mm	4222 2134 26
50mm	41mm	4222 2134 29
50mm	46mm	4222 2134 32
1 13/16	30mm	4222 2119 58
1 13/16	36mm	4222 2119 62
1 13/16	42mm	4222 2119 66
2	1 3/4	4222 2137 74
2	1 13/16	4222 2137 77
2 1/4	1 5/16	4222 2137 80
2 1/4	1 1/2	4222 2137 83
2 1/4	1 7/8	4222 2137 86
2 1/2	1 7/8	4222 2119 70
2 3/4	2 1/2	4222 2137 89
2 3/4	2 1/16	4222 2137 92
2 3/4	2 1/8	4222 2137 95
2 3/4	2 3/16	4222 2137 98
2 3/4	2 1/4	4222 2138 01
2 3/4	2 3/8	4222 2138 04

5 ALCO ARM



Model	Ordering no.
RTX02-ALC	8434 2057 58
RTX04-ALC	8434 2057 60
RTX08-ALC	8434 2057 62
RTX14-ALC	8434 2057 64
RTX18-ALC	8434 2057 66
RTX30-ALC	8434 2057 67

6 ONSIDE REACTION ARM



Model	Ordering no.
RTX02-14	4222 2107 14
RTX04-14	4222 2109 27
RTX08-14	4222 2110 44
RTX14-14	4222 2141 22
RTX18-14	4222 2141 23
RTX30-14	4222 2144 43

4 SAFETY HANDLE



Model	Description	Ordering number
	Handle kit RL-02	8434217035
	Handle kit RL-04	8434217036
	Handle kit RL-08	8434217037
	Handle kit RL-14	8434217038
	Handle kit RL-18	8434217039
	Handle kit RL-30	8434217040

7 SAFETY NUT



Stud Size	Ordering Number
2"	8434212919
2-1/2"	8434212918
2-1/4"	8434212916
1-7/8"	8434212915
3"	8434212913
2-3/4"	8434212912
1-3/4"	8434212910
1-5/8"	8434212909
1-1/2"	8434212907
1-3/8"	8434212906
1-1/4"	8434212904
1-1/8"	8434212903
1"	8434212901
7/8"	8434212900